

IDP Entry-Fit™ Steel Door Frames

Installation Instructions K2A and NK2A Series Frames



INTERNATIONAL DOOR PRODUCTS

IDP Inc
21300 W. 8 Mile Rd.
Southfield, MI 48075
1-877-645-2770
www.idpframes.com
email: info@idpframes.com



INTERNATIONAL DOOR PRODUCTS

IDP Inc. Entry-Fit™ Steel Door Frames

K2A and NK2A SERIES ADJUSTABLE FRAME INSTALLATION INSTRUCTIONS

TOOLS REQUIRED

- Safety glasses
- Cordless drill with magnetic holder & #2 phillips bit
- Tape measure
- Utility knife or scissors
- Hammer
- Rubber mallet
- Level
- Carpenter's square
- 3/8" Drill bit
- 7/8"-1" wood bit
- 1/2"-3/4" Wood chisel
- Caulking gun with latex caulk

**ALWAYS WEAR EYE PROTECTION
WHEN INSTALLING FRAME & DOOR**

PLEASE READ INSTRUCTIONS COMPLETELY BEFORE BEGINNING INSTALLATION

K2A and NK2A SERIES FRAME COMPONENTS

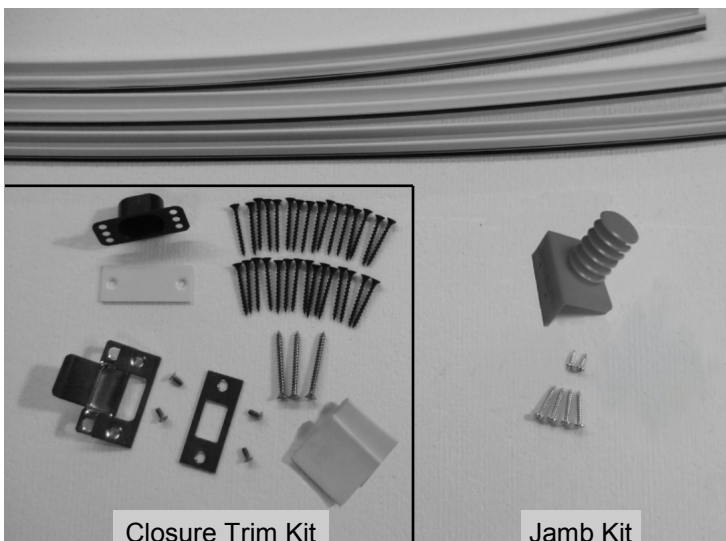

Closure Trim Kit

Jamb Kit

Jamb Kit

- 1 ea. Strike jamb (not shown in pictures)
- 1 ea. Hinge Jamb (not shown in pictures)
- 1 ea. Header (not shown in pictures)
- 1 ea. Sill (not shown in pictures)
- 2 ea. Weather-strip for hinge and strike jamb
- 1 ea. Weather-strip for header
- 1 ea. Plastic pre-hang bracket
- 1 bag Pre-hang fasteners

Closure Trim Kit

- 2 ea. Jamb closure trim (not shown in pictures)
- 1 ea. Header closure trim (not shown in pictures)
- 1 ea. Sill extender if required (not shown in pictures)
- 2 ea. Corner seals
- 1 bag Installation fasteners, adjustable T-strike, deadbolt strike, deadbolt strike box and blank cover for deadbolt prep

PRE-HANG FASTENERS



- 4 ea. #8 x 1" Pan Head Screw for Sill



- 2 ea. #6 x 1/4" Type F Pan Head Self-Tapping Screw for Pre-hang Bracket

INSTALLATION FASTENERS



- 4 ea. #8-32 x 3/8" Flat Head Screw for Strike Plates



- 30 ea 1-5/8" Drywall screw for fastening frame to wall



- 3 ea. #10 x 2" Flat Head Phillips Security Screw for Hinges

K2A-SERIES FRAMING AND FASTENING

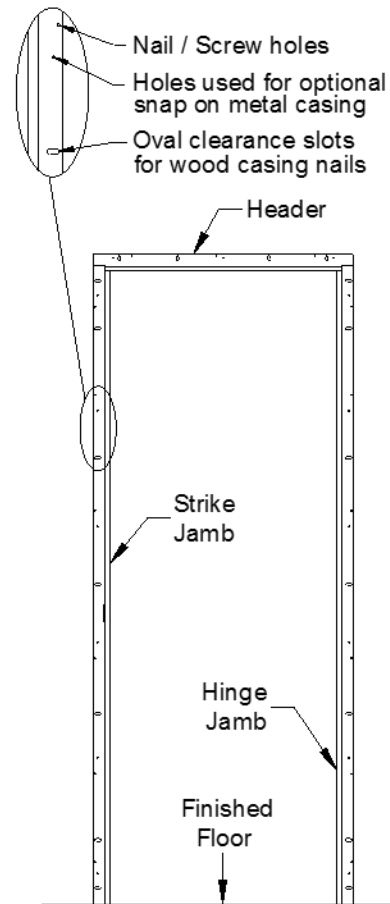
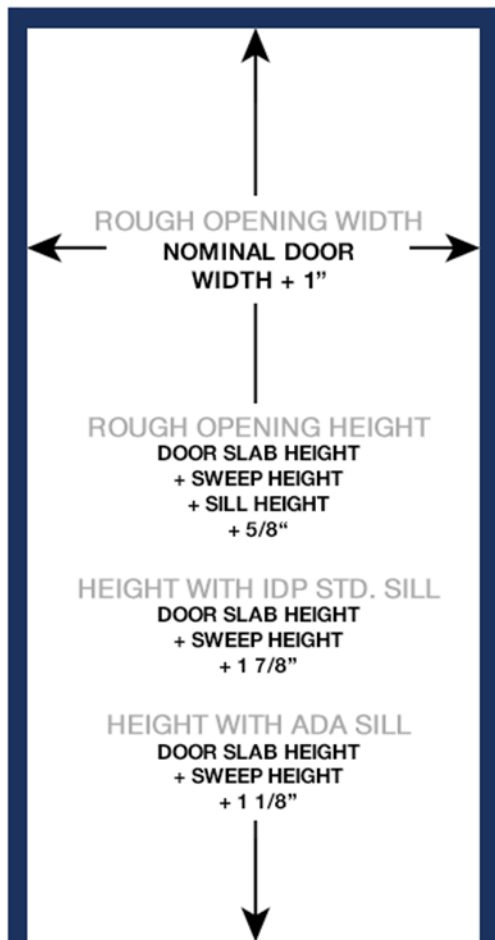

Note: For fire rated frames fasteners must be at least 1/2" longer than the thickness of the drywall or sheathing.

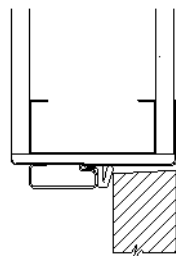

Wall Construction
Metal Studs & Drywall
Recommended Fasteners:
1-1/4" (min.) Type
"S" Bugle Head Self-
Tapping Screws
(not provided)

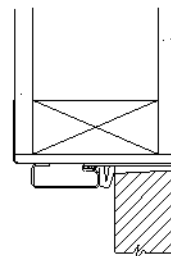

Wall Construction
Wood Studs & Drywall
1-1/4" (min.)
Drywall screws
Coarse thread
(Provided)
or
6d common nails

IDP Inc. Entry-Fit™

Steel Door Frames

K2A and NK2A SERIES ADJUSTABLE FRAME INSTRUCTIONS FOR INSTALLING A PRE-HUNG DOOR



1. Place bottom of door assembly in bottom of opening. Lean top of door away from wall. Have a helper caulk bottom of sill. Stand door upright, centered in opening and against wall.

See Step 9 & 10 - Before caulking it may be easier to hold pre-hung assembly in place and mark clearance for dead bolt and then clearing for deadbolt prior to actual installation.



3. Install the remaining screws in the hinge jamb starting at top, checking for plumb as you work toward the bottom.



5. Close door and secure strike jamb using a 1/8" spacer to obtain a consistent gap as you work toward the bottom. Install remaining screws in header.



7. Slide header closure trim into header. Adjust vertical and header closure trims to obtain a good fit in the top corners.



2. Use a level to plumb hinge jamb. Secure near top corner with a drywall screw.



4. Remove pre-hang clip and open door. Use a carpenter's square to square header to hinge jamb. Install one drywall screw in center of header.



6. Move to other side of door. Slide the jamb closure trims into the jambs as shown above, starting at the bottom.

K2A and NK2A SERIES ADJUSTABLE FRAME
INSTRUCTIONS FOR INSTALLING A PRE-HUNG DOOR
(continued)



8. Secure the header closure trim and jamb closure trim near the top corners first to maintain a tight square fit in the corners. Properly installed closure trim does not narrow into the opening or spread apart allowing for unsquared condition to the wall. Insert the remaining screws. 6 screws per each vertical closure trim and 3 per header closure trim.



9. Prepare stud for deadbolt clearance. Bore a 7/8"-1" hole to a depth of 1" from rabbet of frame. Drill a 3/8" dia. hole at each corner to a depth of 1" from rabbet of frame.



10. Clear out the remaining wood with a wood chisel. *Note: Step 9 & 10 may be easier done before complete installation of pre-hung frame assembly.*



11. Test depth and clearance with the plastic deadbolt strike box.



12. Pull weather-strip out of the kerf near sill to allow room for caulking. Install sill extender if required.



13. Use a high quality latex caulk to seal all gaps between jambs and sill. Allow caulk to set before reinserting weather-strip. Also caulk the outside of sill and closure trim to floor. For exterior applications caulk frame to closure trim at both jambs and header, as indicated by arrow above.

14. Install lockset and deadbolt per manufacturer's instructions. Install adjustable T-Strike or strike plate supplied with lockset, whichever is applicable. Install deadbolt strike plate and plastic dust box or blank plate. Use two # 8-32 x 3/8" flat head screws for strike plate fastening.

15. Install 3 - #10 x 2" Flat Phillips Head Security Screws, 1 per each hinge in to wall stud.

WARNING

The 90 minute fire rating is VOID unless this frame is installed with the closure kit and according to the instructions.